

ONLY FOR THE DEMARCATON AND DEVELOPMENT PURPOSE

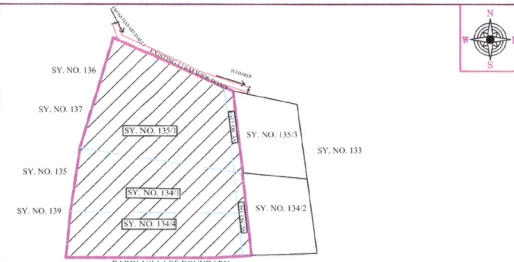
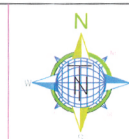

LAND USE ANALYSIS

Extent:-151959.59 sqm
Acres=37 Guntas=22

SL NO	LAND USE	AREA IN sqm	% AGE
1	RESIDENTIAL	82826.48	54.51
2	COMMERCIAL	734.48	00.48
3	C.A	7600.79	05.00
4	PARKS	15212.13	10.01
5	ROADS	45585.71	30.00
TOTAL		151959.59	100.00

SITE ANALYSIS

SL NO	SITE DIMENSION	NO
1	12.19X18.29	32
2	9.14X15.24	87
3	9.14X13.71	87
4	9.14X12.19	363
5	ODD (O)	66
TOTAL		635

CONVERSION ORDER NO.

SL. NO.	SY. NO.	CONVERSION ORDER NO.	EXTENT (A - G)	A-KHARAB (A - G)	TOTAL EXTENT
1	SY.NO. 134/1	APPLICATION NO. 530016 DT:15-09-2023	11 - 03	00 - 10	11 - 13
2	SY.NO. 134/3	APPLICATION NO. 530019 DT:15-09-2023	01 - 00	---	01 - 00
3	SY.NO. 134/4	APPLICATION NO. 530018 DT:15-09-2023	09 - 00	---	09 - 00
4	SY.NO. 135/1	APPLICATION NO. 530013 DT:15-09-2023	15 - 19	00 - 33	16 - 12
5	SY.NO. 135/4	APPLICATION NO. 530021 DT:15-09-2023	01 - 00	---	01 - 00
TOTAL			37 - 22	01 - 03	38 - 25

PROPOSED PROVISIONAL RESIDENTIAL LAYOUT PLAN IN SY. NO. 134/1, 134/3, 134/4, 135/1 & 135/4 OF HASARUHALI VILLAGE, TYMAGONDLU HOBLI, NELAMANGALA TALUK, BANGALORE RURAL DISTRICT.

ALL DIMENSIONS ARE IN METERS SCALE 1:1000

Owner's Signature

M/S JSSCO ENTERPRISES & SERVICES PVT. LTD.

M/S TAXIMENS SERVICES LTD.

SRI. FREDERICK DSA

SRI. G. RAVINDRA KUMAR

G. Ravindra Kumar.

Engineer Signature

M.S. Krishna Reddy

(M.S. KRISHNA REDDY)
BCC/BL-3.6/E-2713/2005-06

ದಾಖಲೆ ಸಂಖ್ಯೆ: 18-12-2023 ರಂದು ನವೆಂಬರ್ 18-12-2023
ಪ್ರಾಧಿಕಾರದ ಸಂಖ್ಯೆ: 117.7.1.1 ರ ನಿರ್ಧಾರದಂತೆ.

ಈ ಪ್ರಾಧಿಕಾರದ ಸತ್ಯ ಸಂಖ್ಯೆ: 18-12-2023
7918083-2023
ದಿನಾಂಕ: 18-12-2023 ರಲ್ಲಿ ನಮೂದಿಸಿದ ವಿವರಗಳನ್ನು ಈ ವಿಷಯವನ್ನು ಅನುಷ್ಠಾನಿಸಲಾಗಿದೆ.

Assistant Director of Town & Country Planning
Nelamangala Planning Authority
Nelamangala.

Deputy Director of Town & Country Planning
Nelamangala Planning Authority
Nelamangala.

Joint Director of Town & Country Planning & Member Secretary
Nelamangala Planning Authority
Nelamangala.